

CARBIDE RODS

Round Blanks

KXF
Micrograin Carbide
0,8 μ , 10% Cobalt
Tolerance
h6, ground and polished

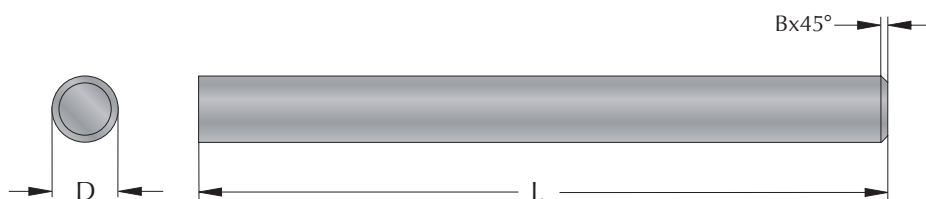

D mm	L mm	B mm	Part Number	Price EUR
3,0	39	0,3	Ø3X39 KXF	3,50
3,0	76	0,3	Ø3X76 KXF	5,50
3,0	100	0,3	Ø3X100 KXF	6,70
3,0	320	0,3	Ø3X320 KXF	19,90
4,0	50	0,4	Ø4X50 KXF	4,30
4,0	100	0,4	Ø4X100 KXF	8,20
4,0	320	0,4	Ø4X320 KXF	25,00
5,0	50	0,4	Ø5X50 KXF	5,80
5,0	76	0,4	Ø5X76 KXF	7,80
5,0	100	0,4	Ø5X100 KXF	11,00
5,0	320	0,4	Ø5X320 KXF	33,20
6,0	63	0,4	Ø6X63 KXF	7,20
6,0	76	0,4	Ø6X76 KXF	8,20
6,0	100	0,4	Ø6X100 KXF	13,60
6,0	320	0,4	Ø6X320 KXF	40,90
8,0	63	0,5	Ø8X63 KXF	11,60
8,0	76	0,5	Ø8X76 KXF	14,80
8,0	100	0,5	Ø8X100 KXF	20,50
8,0	320	0,5	Ø8X320 KXF	61,70
10,0	76	0,5	Ø10X76 KXF	19,30
10,0	100	0,5	Ø10X100 KXF	28,80
10,0	320	0,5	Ø10X320 KXF	86,30
12,0	83	0,5	Ø12X83 KXF	29,90
12,0	100	0,5	Ø12X100 KXF	39,50
12,0	320	0,5	Ø12X320 KXF	118,80
14,0	89	0,8	Ø14X89 KXF	47,60
14,0	100	0,8	Ø14X100 KXF	55,10
14,0	320	0,8	Ø14X320 KXF	165,20
16,0	100	0,8	Ø16X100 KXF	66,40
16,0	120	0,8	Ø16X120 KXF	75,10
16,0	150	0,8	Ø16X150 KXF	99,70
16,0	320	0,8	Ø16X320 KXF	199,60
18,0	100	0,8	Ø18X100 KXF	82,10
18,0	320	0,8	Ø18X320 KXF	246,70
20,0	100	1,0	Ø20X100 KXF	100,30
20,0	120	1,0	Ø20X120 KXF	120,70
20,0	150	1,0	Ø20X150 KXF	150,80
20,0	320	1,0	Ø20X320 KXF	300,90
25,0	100	1,0	Ø25X100 KXF	152,80
25,0	120	1,0	Ø25X120 KXF	183,30
25,0	130	1,0	Ø25X130 KXF	199,20
25,0	150	1,0	Ø25X150 KXF	229,70
25,0	320	1,0	Ø25X320 KXF	458,20
32,0	150	1,0	Ø32X150 KXF	372,30
32,0	320	1,0	Ø32X320 KXF	742,60
40,0	170	1,0	Ø40X170 KXF	667,80

CARBIDE RODS

with Internal Coolant

KXF
Micrograin Carbide
0,8 μ , 10% Cobalt
Tolerance
h6, ground and polished

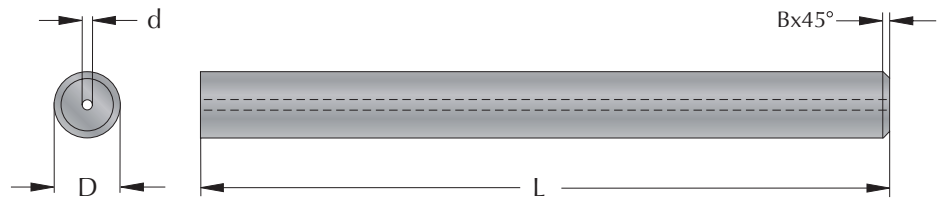

D mm	L mm	d mm	B mm	Part Number	Price EUR
4	50	0,6	0,4	Ø4X50Ø0.6 KXF	8,80
6	63	1	0,4	Ø6X63Ø1 KXF	14,40
8	76	1,3	0,5	Ø8X76Ø1.3 KXF	23,80
10	100	2	0,5	Ø10X100Ø2 KXF	37,30
12	100	2	0,5	Ø12X100Ø2 KXF	50,00
14	100	2	0,8	Ø14X100Ø2 KXF	64,60
16	120	3	0,8	Ø16X120Ø3 KXF	123,50
20	150	3	1,0	Ø20X150Ø3 KXF	183,90

with Internal Radial Coolant

KXF
Micrograin Carbide
0,8 μ , 10% Cobalt
Tolerance
h6, ground and polished

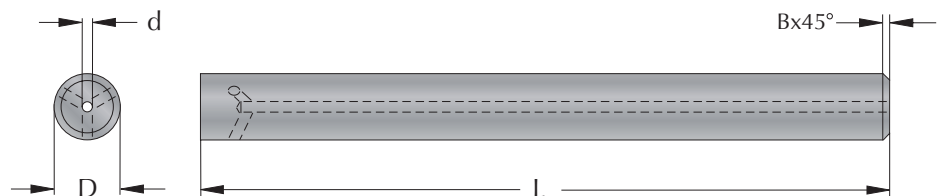

D mm	L mm	d mm	No. of holes	B mm	Part Number	Price EUR
6	76	1	3	0,5	Ø6X76Ø1C KXF	40,20
8	76	1,2	3	1,0	Ø8X76Ø1.2C KXF	51,70
8	76	1,2	4	1,0	Ø8X76Ø1.2D KXF	51,70
10	100	1,2	3	1,0	Ø10X100Ø1.2C KXF	67,90
10	100	1,2	4	1,0	Ø10X100Ø1.2D KXF	67,90
12	100	1,5	4	1,0	Ø12X100Ø1.5D KXF	87,50
16	100	1,5	4	1,5	Ø16X100Ø1.5D KXF	156,20
16	100	1,5	5	1,5	Ø16X100Ø1.5E KXF	156,20

■ SmiCut supply Rectangular Carbide Rods